

INSTALLATION MANUAL RECESSED MILLWORK

INDEX

- A:** SINGLE UNIT INSTALLATION
- B:** CONTINUOUS INSTALLATION
- C:** CORNER INSTALLATION
- D:** WIRING DETAILS



WARNING:

The safety and warranty of this fixture is guaranteed only if installed in compliance with below instruction manual.

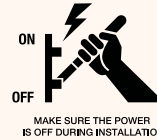

IP20

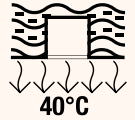

THE LOW SURFACE TEMPERATURE (40°C) IMPOSE NO LIMITS ON INSTALLATION

A. SINGLE UNIT INSTALLATION

Provided Components

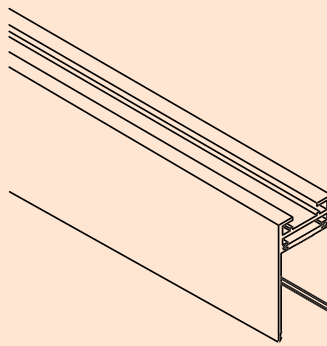

Specter profile-(x1)



End Cap-(x2)

1.

- Pull the low voltage cables through the millwork slot or millwork ceiling opening.

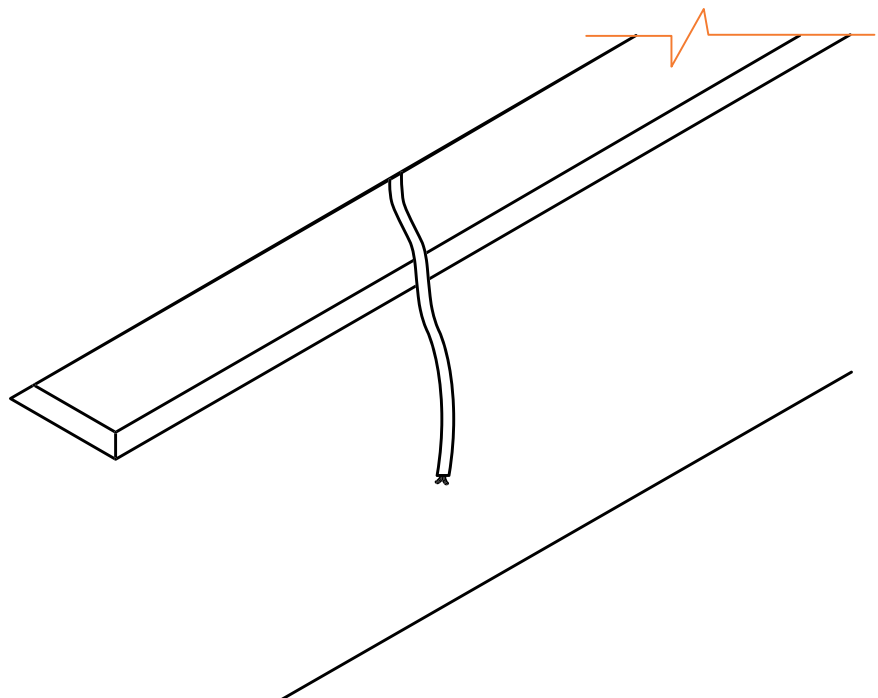

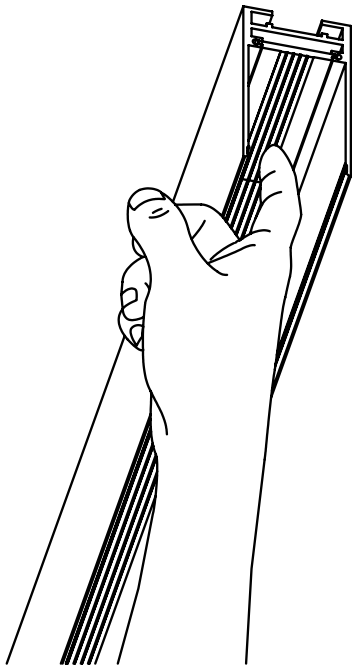

2. ▶ Press the side of decorative plates to remove from profile.



WARNING: Shock hazard. Serious injury or death may occur. Turn Off power before servicing or installing. Wire according to local and national codes. This product shall be installed by a qualified electrician.

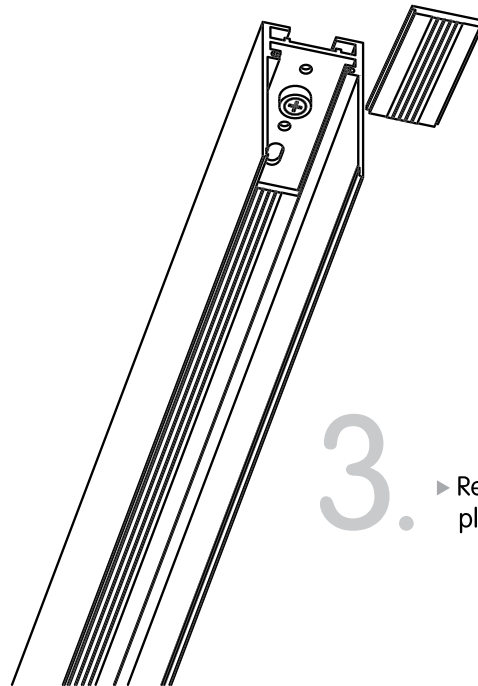

3. ▶ Remove the decorative plates on ends of profile.

4.

- ▶ Screw the end caps on both sides of the profile.

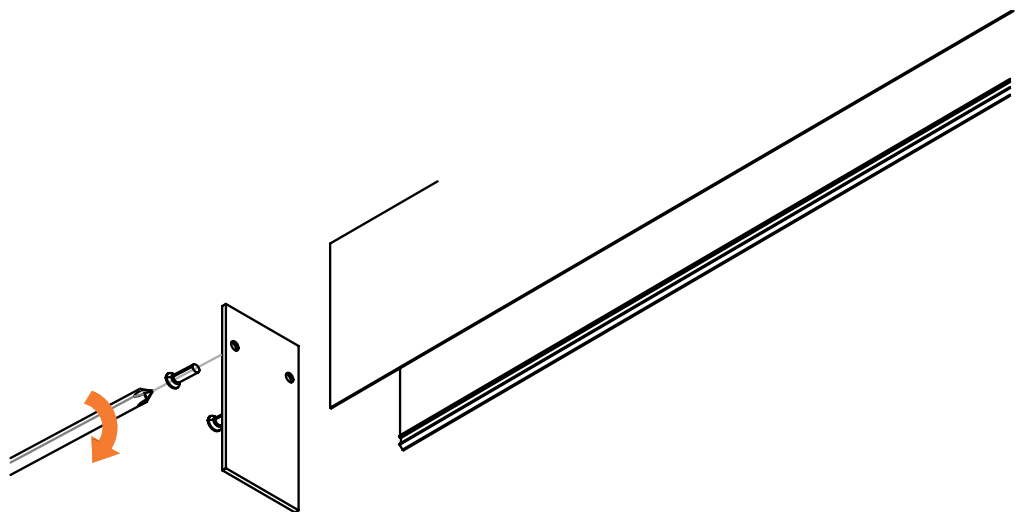

WARNING: Failure to secure safety cables can lead to injury or death!

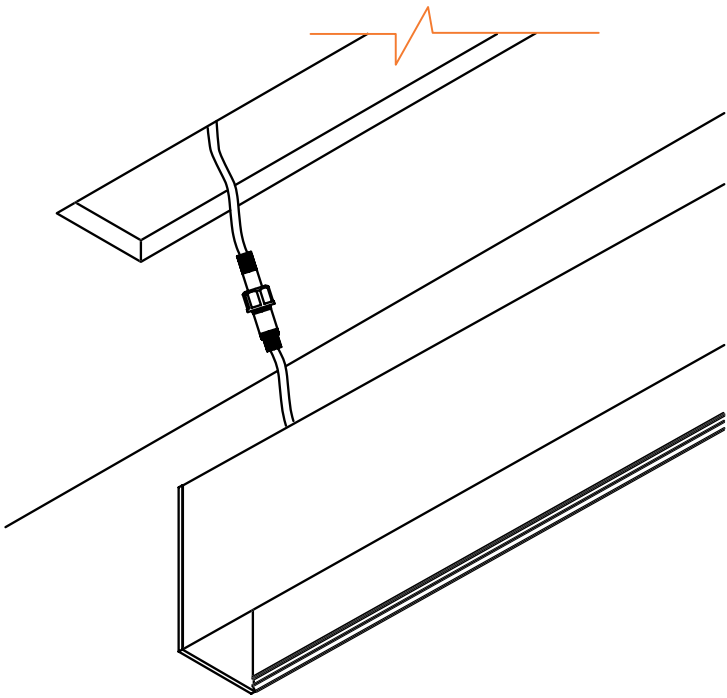

5. ▶ Lift the profile and connect it to the low voltage cable.

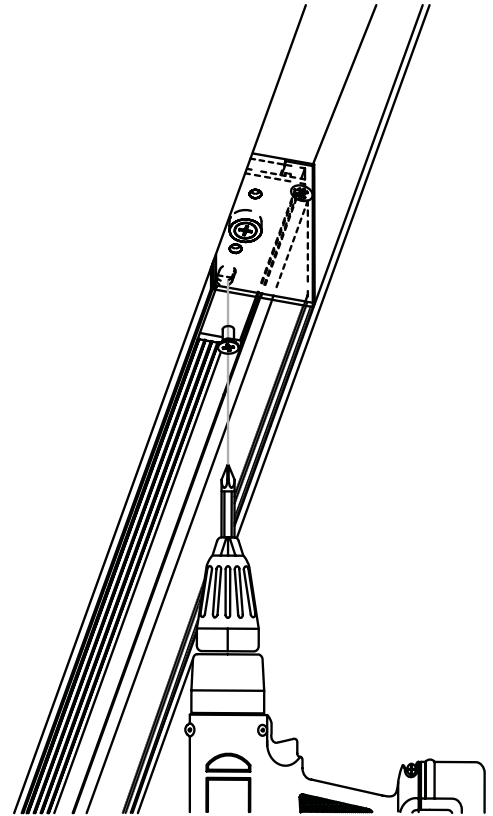

6. ▶ Fasten the profile in the millwork slot on both sides.

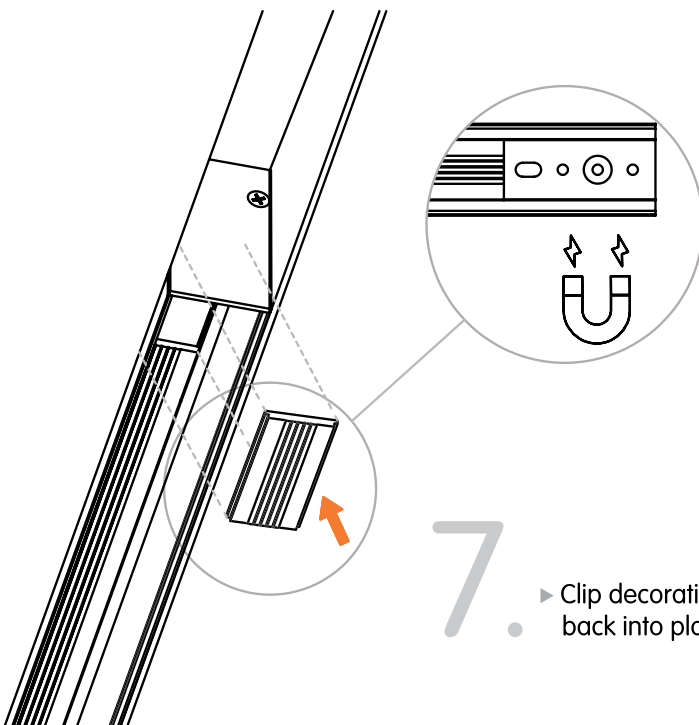

7. ▶ Clip decorative plates back into place.

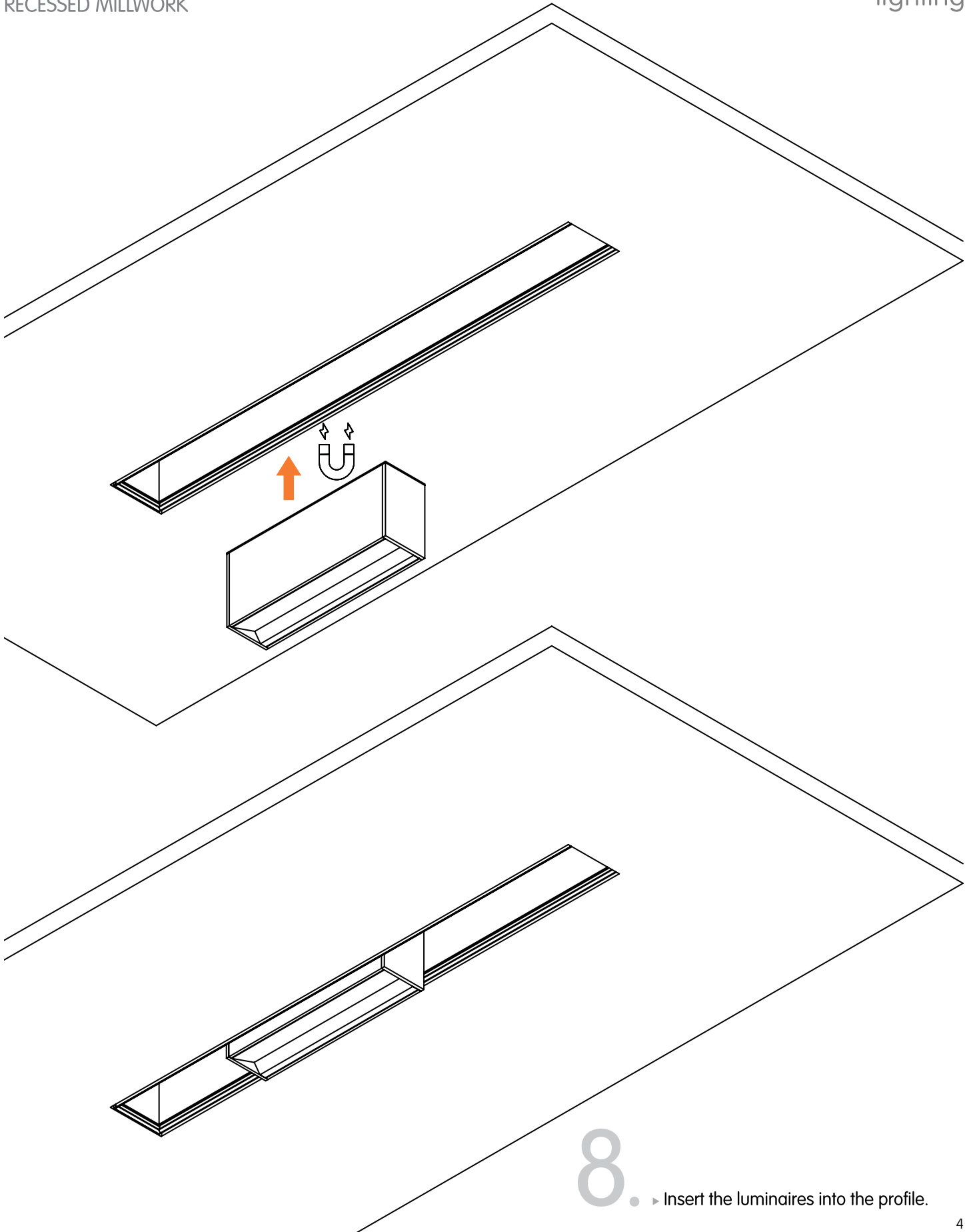

B. CONTINUOUS RUN INSTALLATION

Provided Components

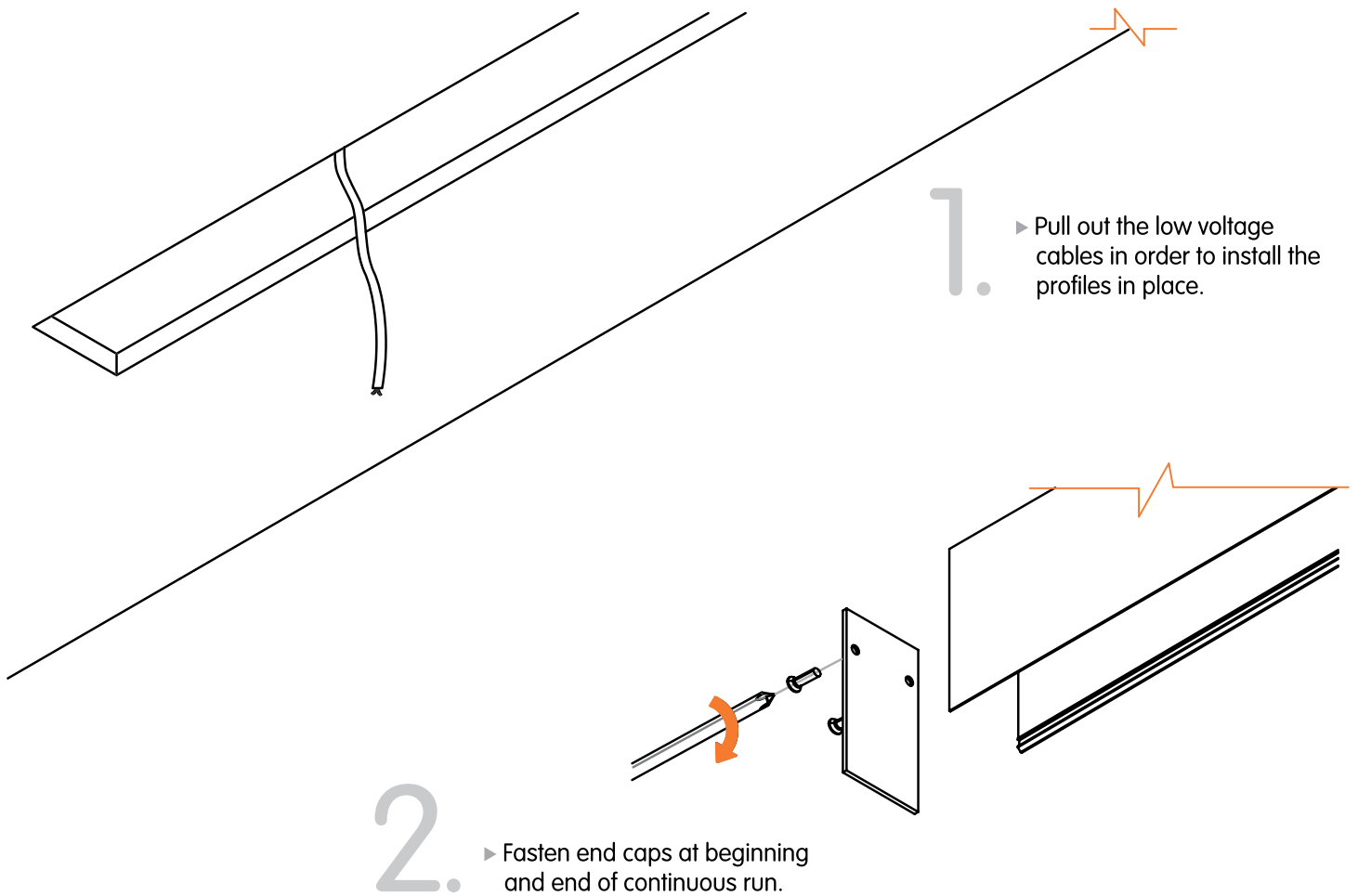
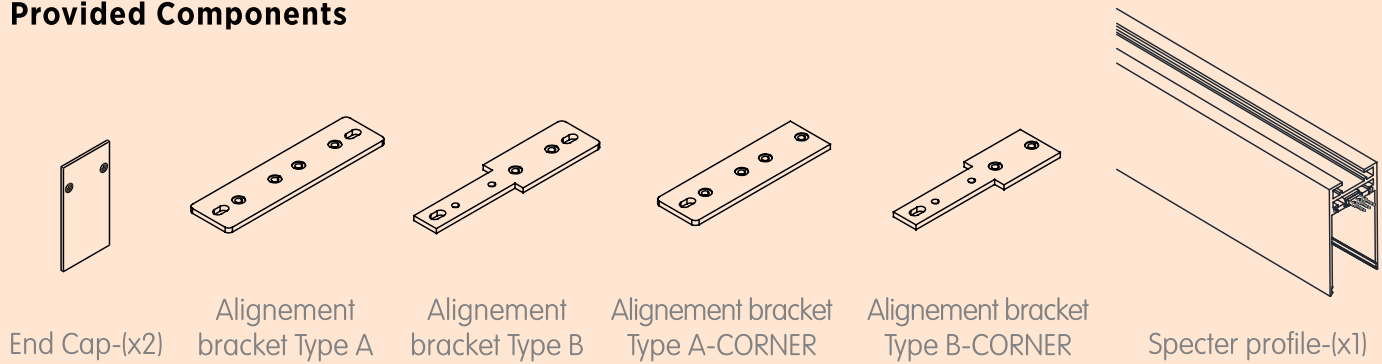

3. ▶ Remove decorative plates per Section A.

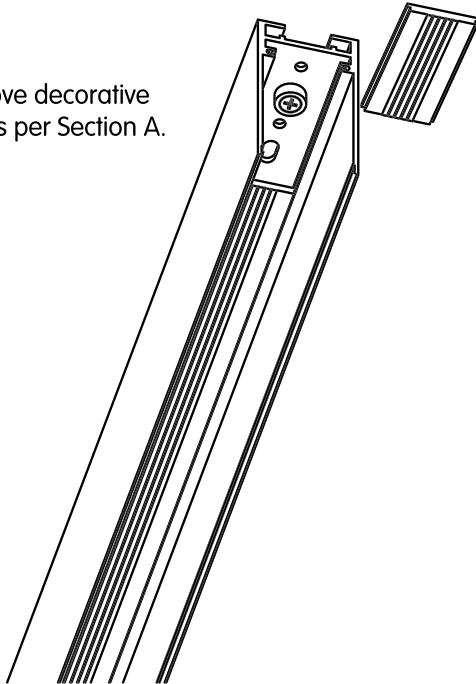

4. ▶ Install alignment brackets (Type A) at the ends of all profiles using provided screws.

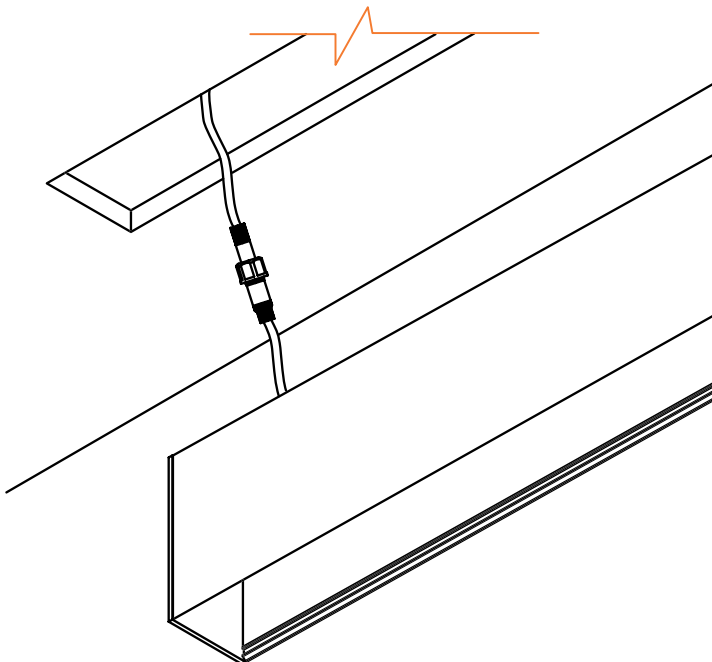
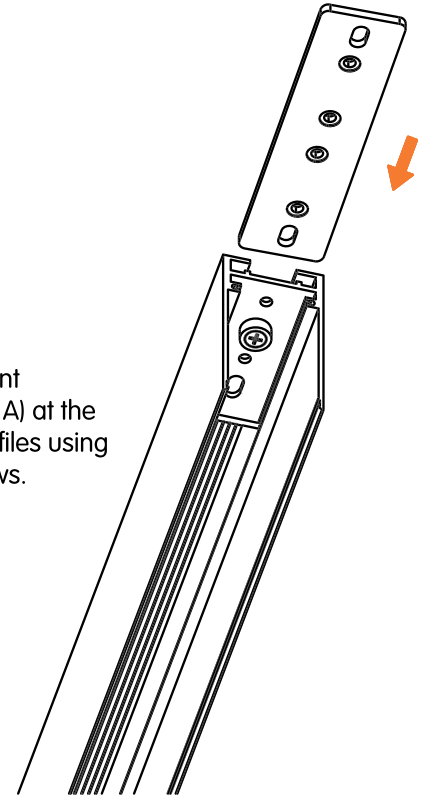

5. ▶ Lift the first of run profile and connect it to the low voltage cable.

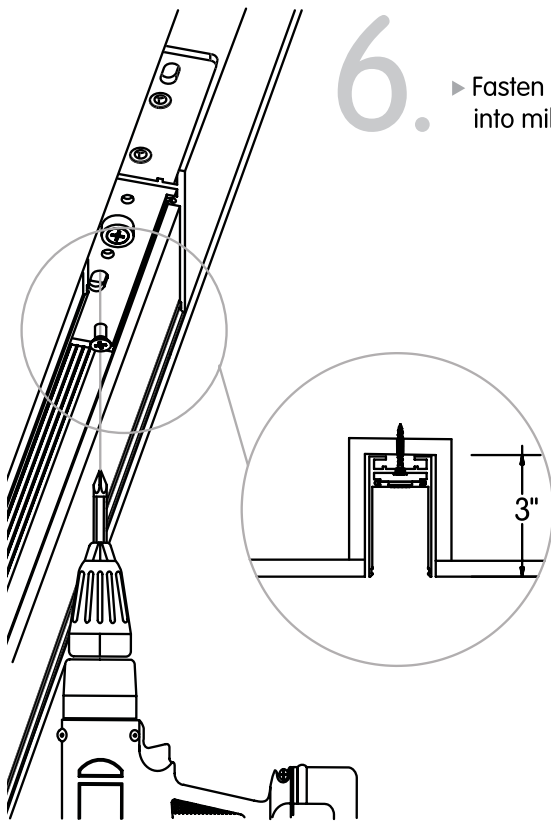

6. ▶ Fasten the first of run profile into millwork slot.

7. ▶ Install middle of run profiles.

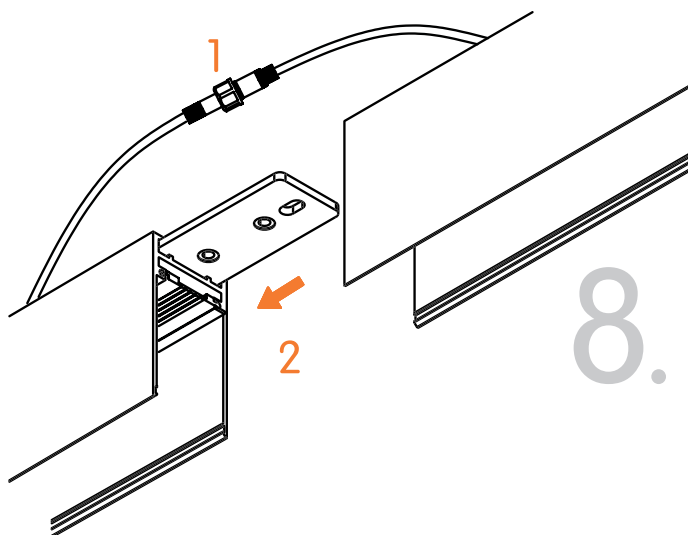
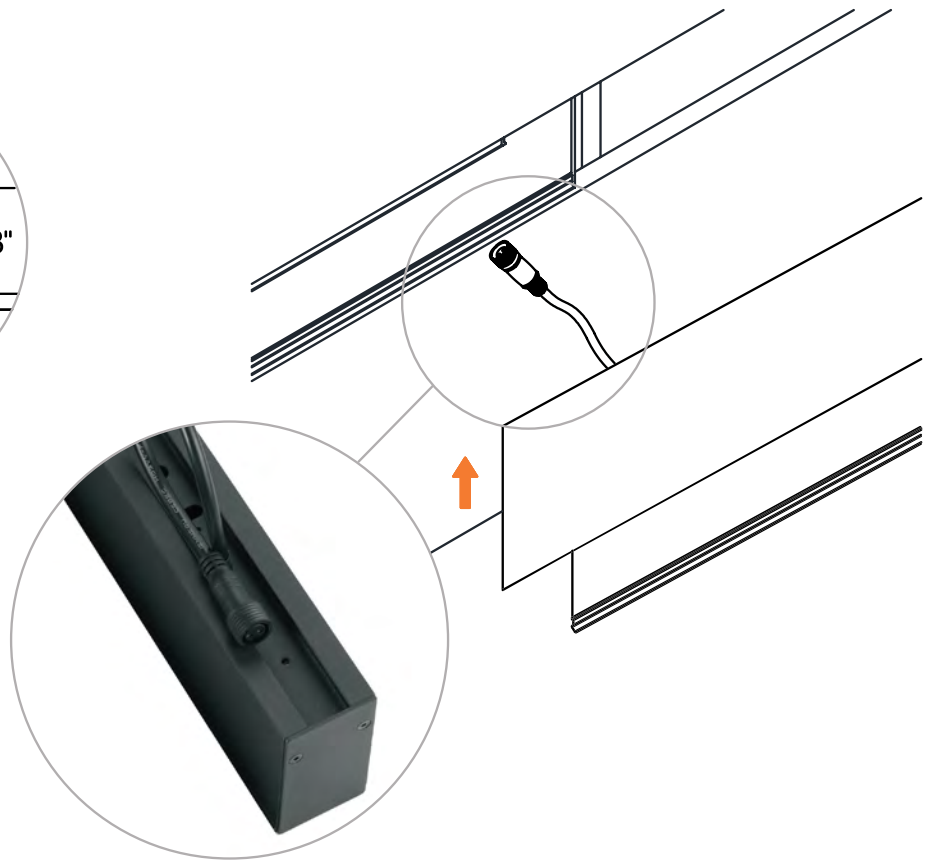

8. ▶ 1- Connect profiles together using the provided lead cables.
▶ 2- Slide middle of run profile into the alignment bracket of neighboring profile.
▶ Note: Refer to the factory shop drawings for the through wiring details.

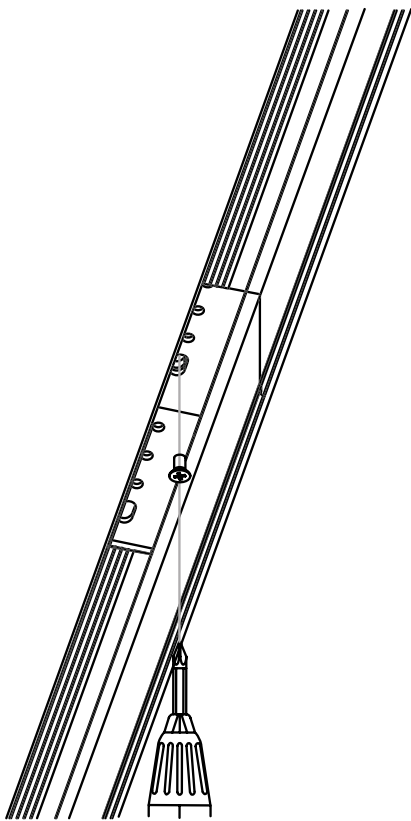

9.

- Repeat previous steps to install all profile sections except end of run profile.

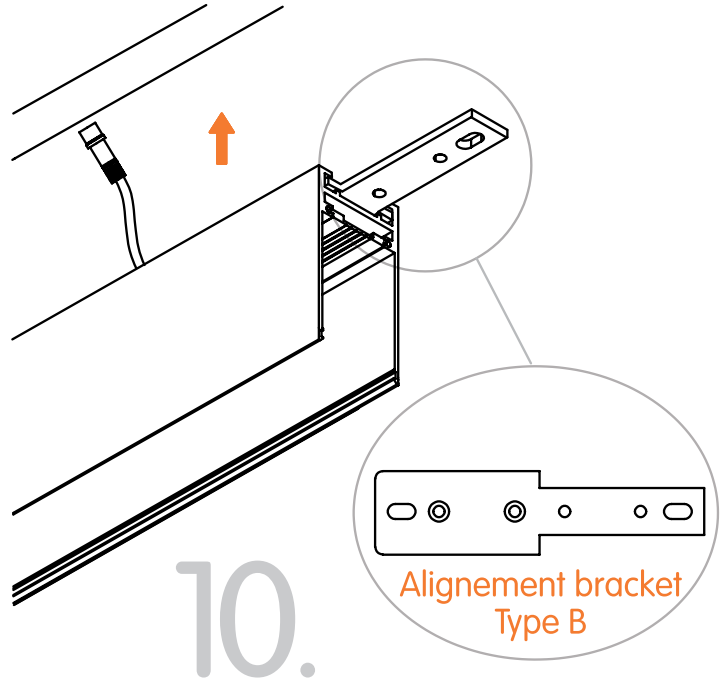

10.

- Fasten alignment bracket (Type B) to the last profile section before the end-of-run profile.

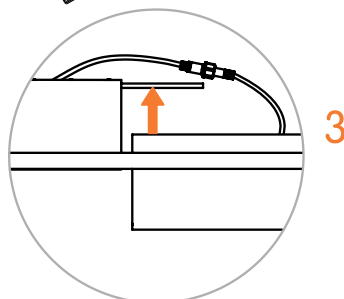
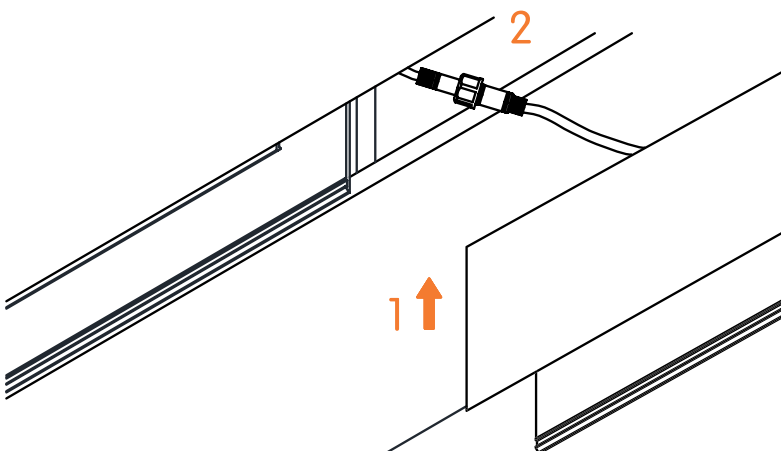

11.

Note:

- 1- Lift the end of run profile.
- 2- Connect profile cables together.
- 3- Insert end-of-run profile through the alignment bracket type B of the neighboring profile.

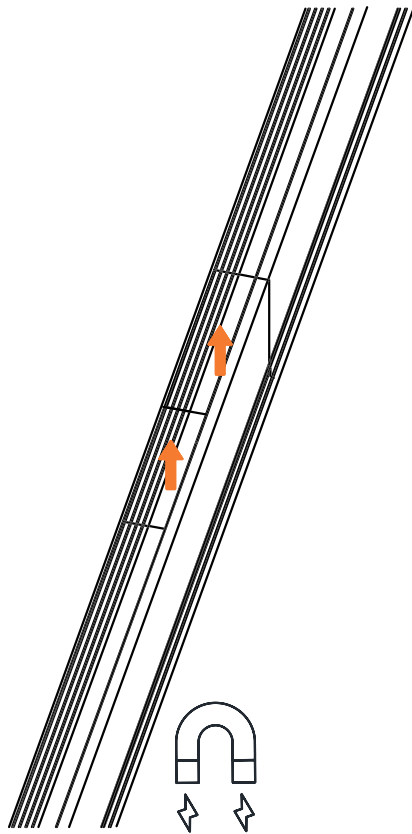

12.

► Clip back the decorative plates in place.

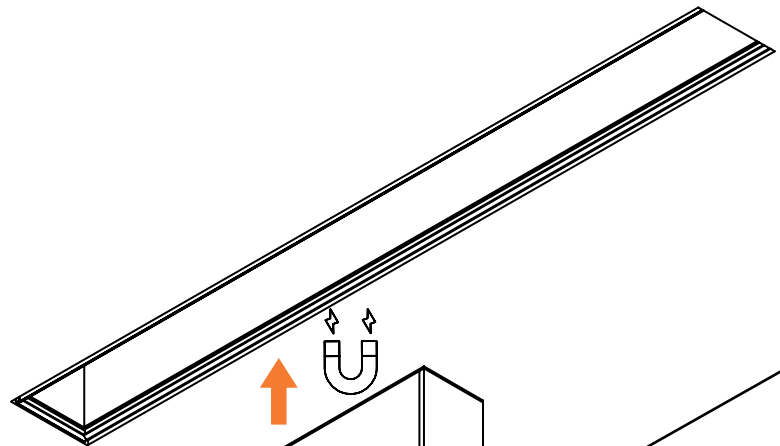

13.

► Insert the luminaires into the profiles.

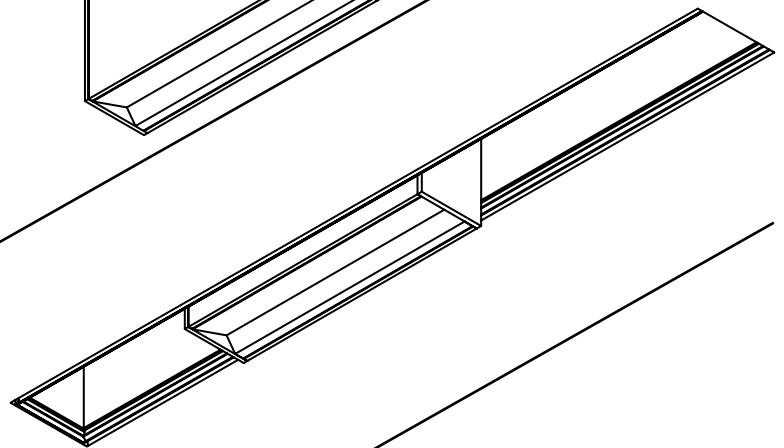

WARNING: Do not exceed the rated wattage of the through wiring cables or the connectors. For all continuous runs, refer to factory shop drawing indicating exact dimensions and feed locations.

C. CORNER CONNECTION

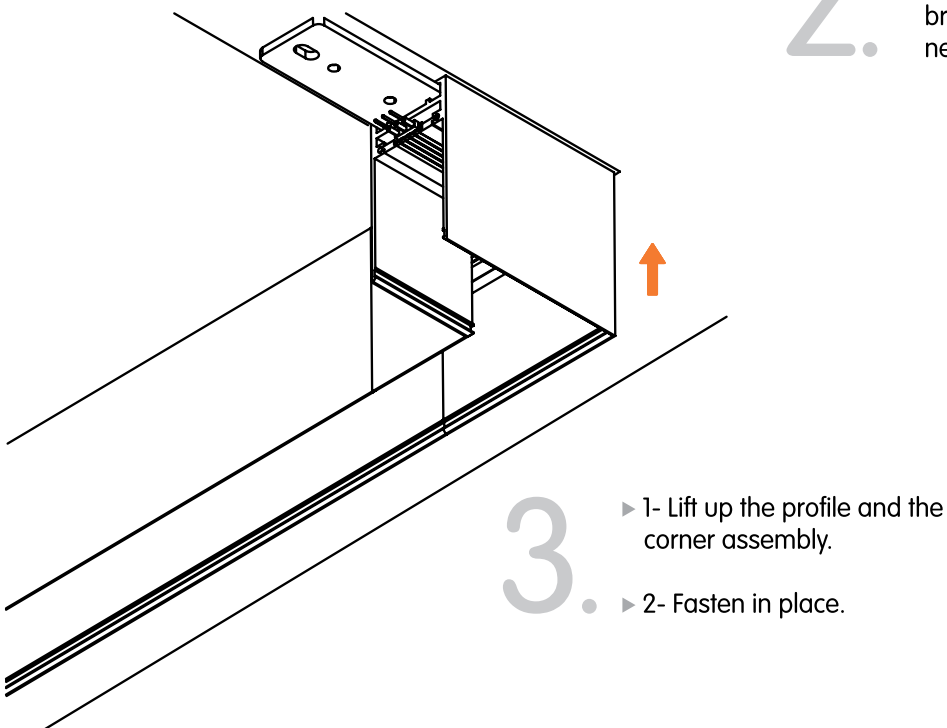
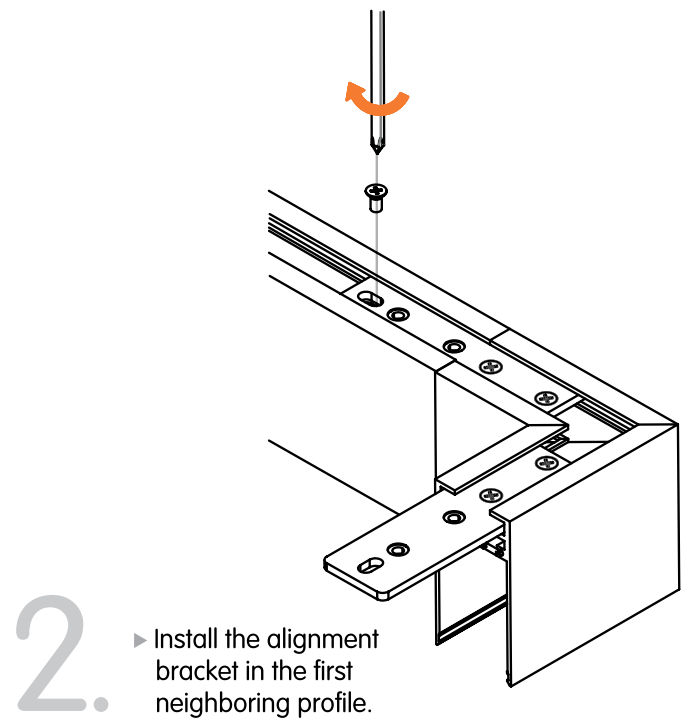
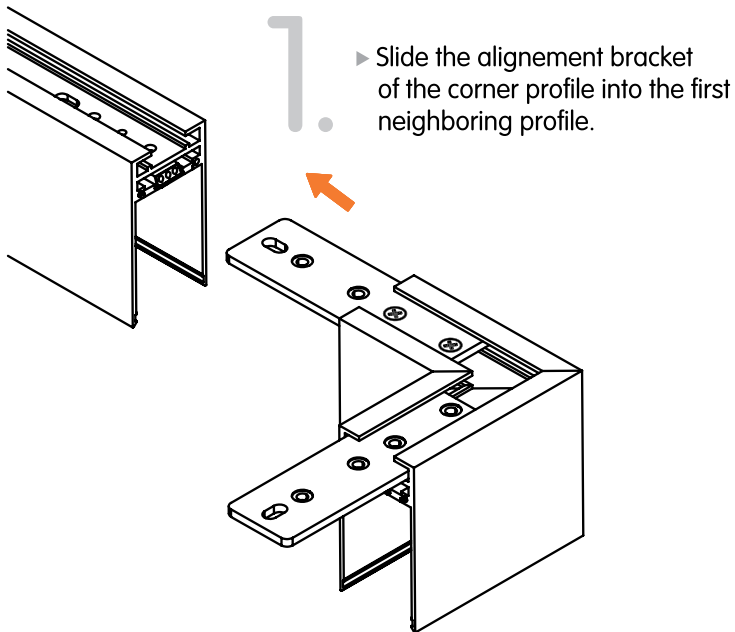

4.

► Lift up the neighboring profile.

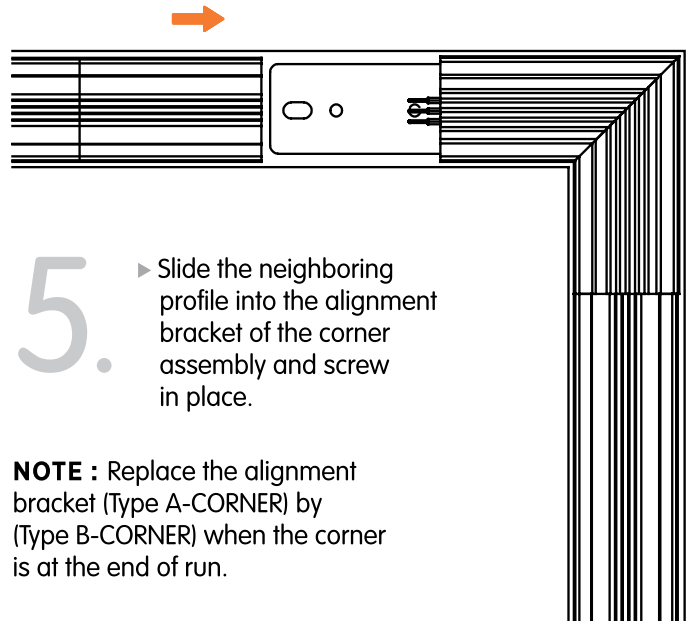
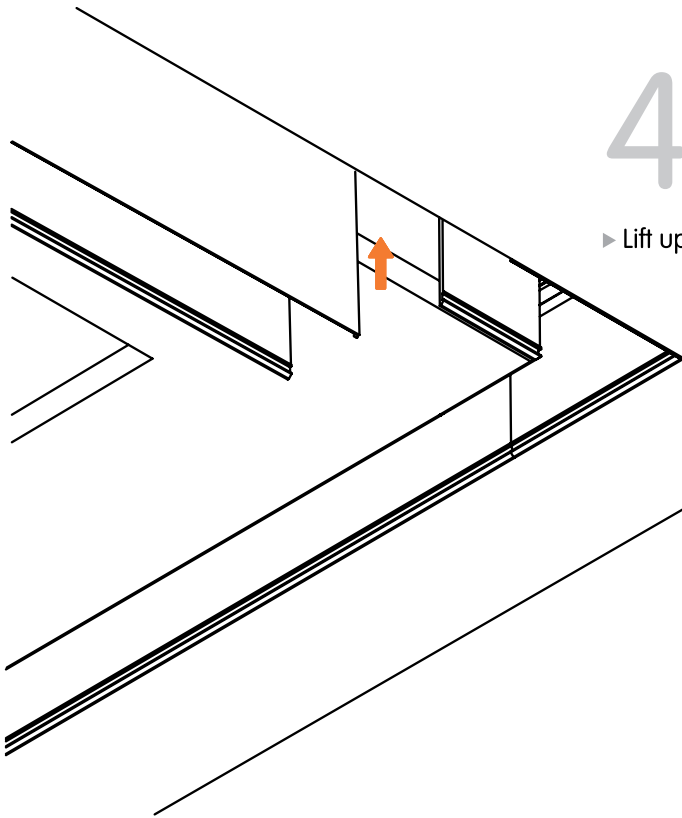

5. ► Slide the neighboring profile into the alignment bracket of the corner assembly and screw in place.

NOTE : Replace the alignment bracket (Type A-CORNER) by (Type B-CORNER) when the corner is at the end of run.

ELECTRICAL CONTINUITY

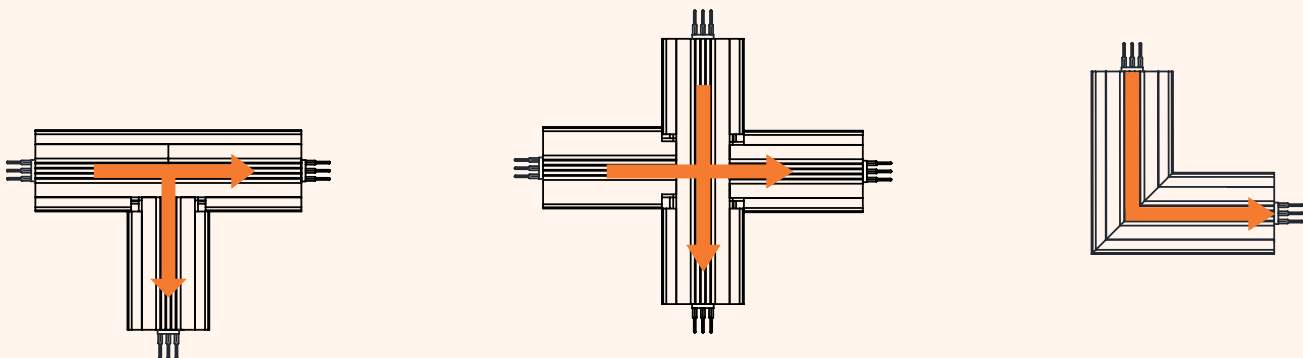

D. WIRING DETAILS

MAXIMUM RECOMMENDED DISTANCE FROM FIRST FEED TO REMOTE DRIVER (Track length considered 20ft)

Wire Gauge	Wattage	Maximum Lead Length
16 AWG (1.0 mm ²)	60 W	100 ft (30.4 m)
	120 W	70 ft (21.3 m)
	150 W	50 ft (16.4 m)
	200 W	35 ft (10.7 m)
	300 W	15 ft (4.7 m)

MAXIMUM RECOMMENDED LOAD RELATIVE TO LENGTH OF TRACK (Driver considered at 15ft from first feed)

Length of Track	Max. Load in W
165 ft (50 m)	100 W
130 ft (40 m)	120 W
100 ft (30.4 m)	150 W
70 ft (21.3 m)	200 W
35ft (10.7 m)	300 W
15 ft (4.7 m)	400 W

ELV DIMMING WIRING DIAGRAM

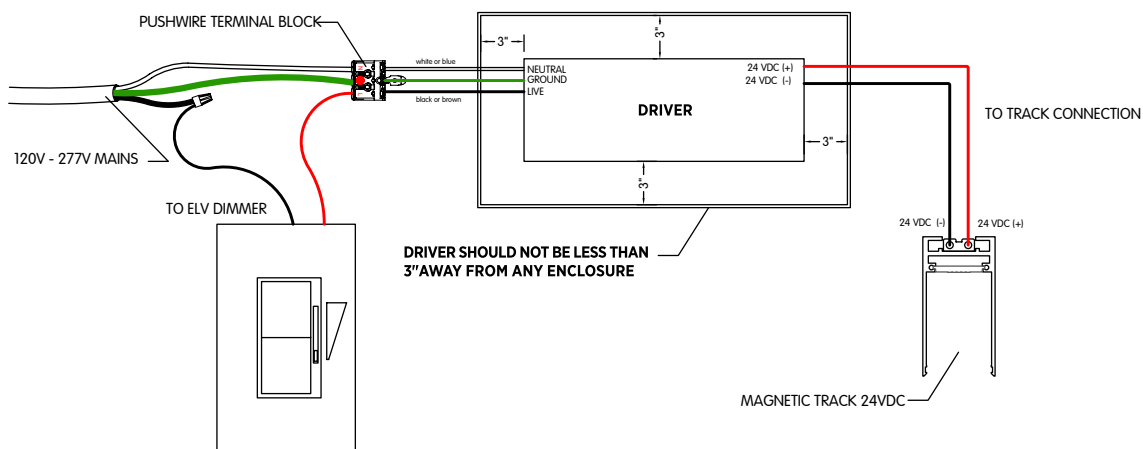

DALI DIMMING WIRING DIAGRAM

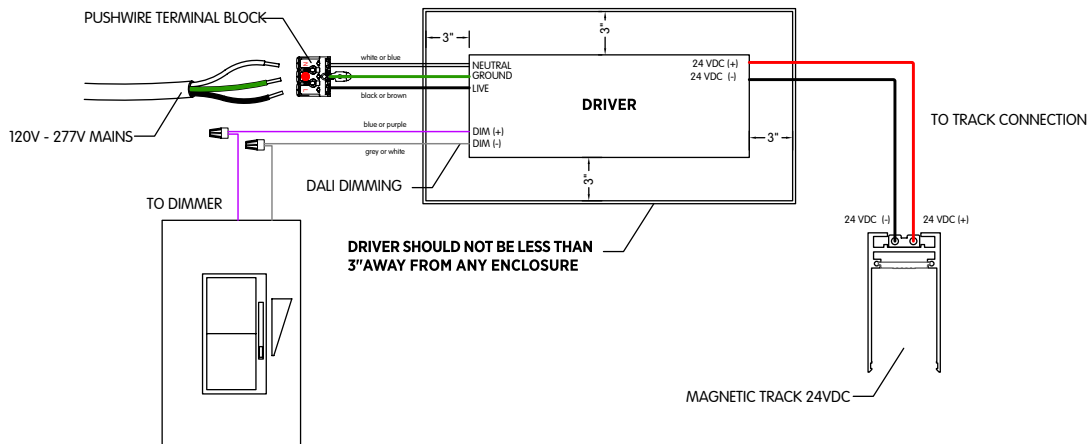

0-10V DIMMING WIRING DIAGRAM

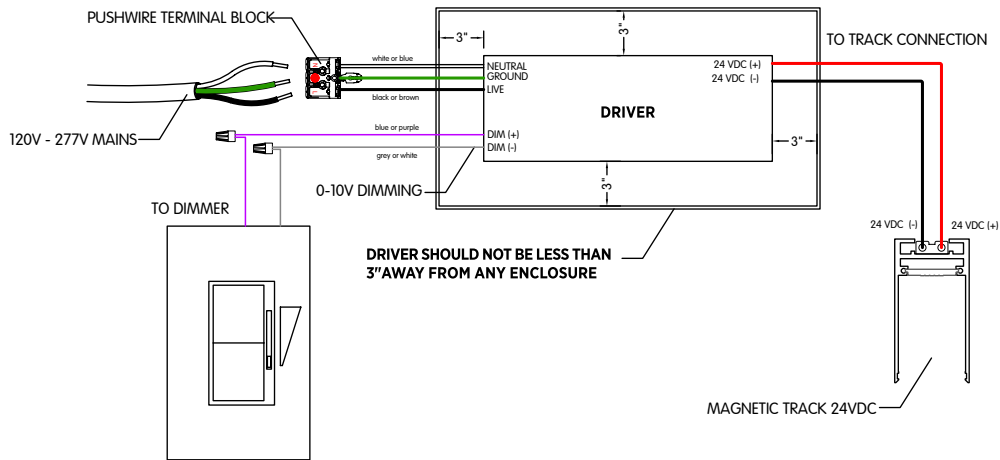

2 CIRCUIT TRACK WIRING DIAGRAM

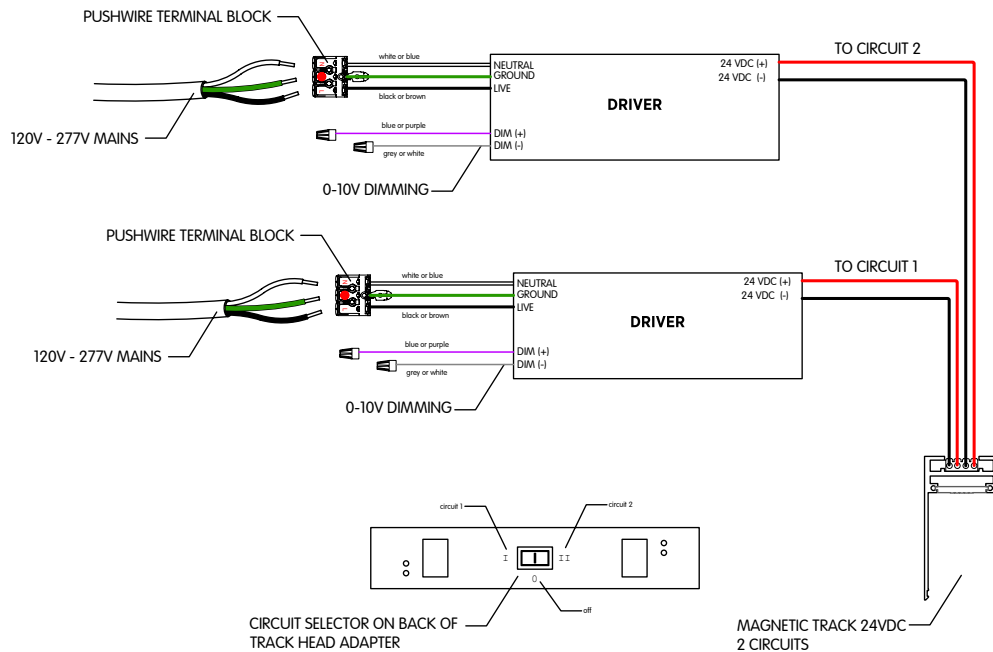

Failure to follow the wiring color coding and connectors pin labeling will void the fixtures warranty.